

Foam-Flite

TableTop Airplane Stand

Thank you for purchasing a Foam-Flite model airplane stand. Your Foam-Flite stand was designed by modelers just like you looking for an economical and versatile stand to make it easier to work on and protect model aircraft on the workbench and at the field. We hope you enjoy your stand and find many uses for it. If you have any questions please contact us. The Foam-Flite tabletop stand kit includes all the wood and hardware for one complete stand. Check over the parts and hardware before you start your build. If there are any damaged pieces or missing hardware please contact us before beginning the assembly process. To assemble the Table Top Airplane Stand you will need the following tools:

- #2 Phillips Screwdriver
- Powered drill with 5/64" and 9/32 Drill Bits
- Wood Glue
- Hobby Knife
- Sandpaper
- 4-8 spring clamps

1) Locate the long base pieces and the center spacer. Notice that there is a notch cut into the base of each piece on one side.

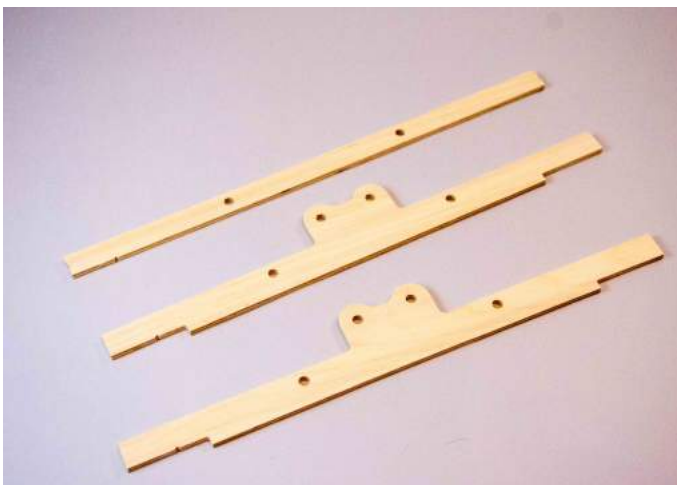

2) Make sure the notches line up on the same side. Apply a bead of glue to one side of

the inner spacer make sure not to get glue in the large 9/32" holes for the bolts. Using the notches as a guide stick the center spacer to the first long rail. Apply glue to the other side of the spacer and place the other long rail on using the holes and notches to line them up. To perfectly align the pieces insert a 9/32" drill bit into the large holes.



3) Clamp the parts together using spring clamps and wipe up any excess glue from the sides. Set this aside to setup.

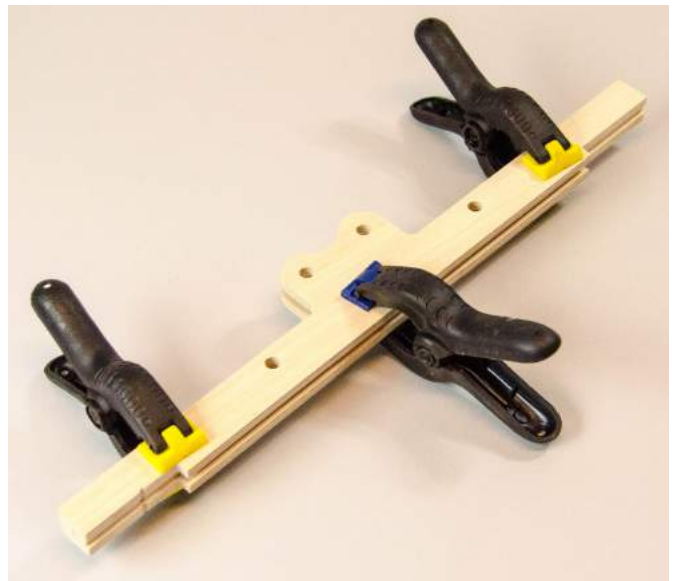

4) Locate the footer pieces. Apply glue to one side of the footer piece with the notch cut out of the bottom. Line this up on the full footer piece making sure the center hole is aligned and the feet are flat on the bottom. Clamp together and wipe off any excess glue. Repeat this for the opposite side.

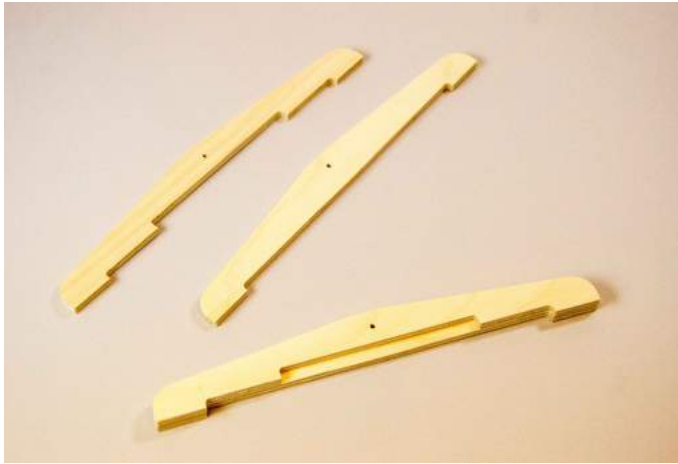

5) Once the glue has setup on the base pieces remove the clamps. Using a 5/64" bit drill pilot holes in each end in the center of the notches. Using the Phillips head screwdriver make a countersink in the predrilled hole on the outside edge of the footer piece. Start a 1" screw into the piece. Apply some glue to the end of the base piece and line up the footer to the base piece. Tighten the screw to hold the piece in place. Repeat this step for the other side.



6) With both footer pieces fixed to the ends place the assembly on a flat surface and adjust the fit so it sits level and let it sit till the glue dries.



7) Flip the base piece over and apply glue for the triangle braces. Place the braces in place and wipe off any excess glue. Let the assembly dry.



8) Locate the rail arm pieces. The center piece has 4 notches, start by drilling a 5/64" pilot hole in the center of each notch. (note the pic shows 6 but updated kits only have 4)





- 9) Using the Phillips head screwdriver add countersinks to each of the holes on the two side rail pieces. Then start a 1/2" screw in each hole.

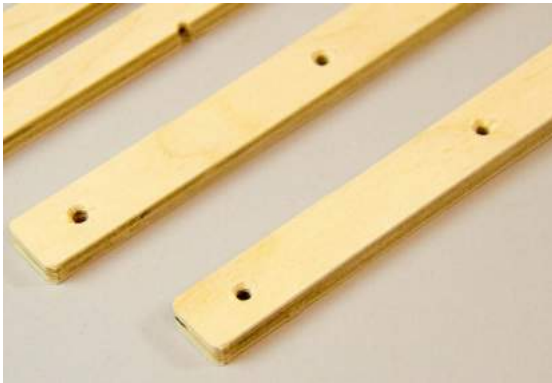

- 10) Apply glue to the side of the centerpiece and line up the side rails. Tightens the screws down and wipe off any excess glue.

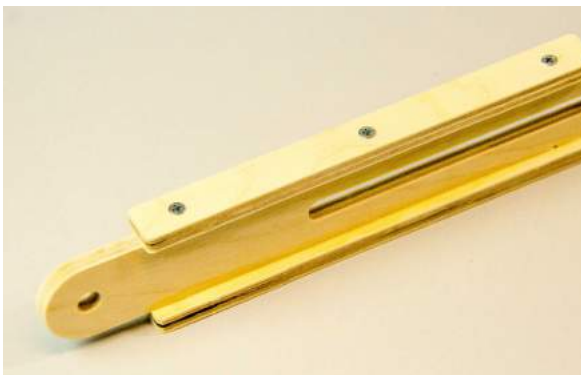

- 11) Using the 1" stove bolt install the rails into the center holes on the base of the stand. Place a washer on the opposite side and tighten the bolt into the wood using a 1/4" wing nut. Once the bolt head is fully seated in the wood loosen the wing nut just enough so you can move the arm.



- 12) Locate the 2 arm extensions and brace pieces along with the 1 1/4" stove bolts. Start by attaching the brace pieces to the stands base using the 1 1/4" stove bolts.



13) Slide the two arm extensions into the rail and rotate the brace pieces up and line up the bolt holes. Using another 1 ¼" stove bolt attach the extension arms to the rail. Make sure all of the stove bolt heads are fully seated and repeat for the opposite side.



14) Locate the wishbone shaped clamp base and the trapezoid shaped pivot piece.



15) Drill two pilot holes in the center of the notches of the pivot piece.

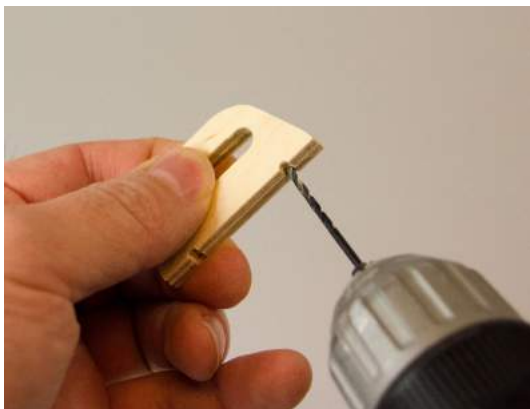

16) Using the Phillips head screwdriver add countersinks to the two pilot holes in the clamp base.



17) Apply glue to the pivot piece and secure it to the clamp base using two ½" #4 screws.



18) Locate the angled clamp arms and ¾" stove bolts. Attach the arms to the clamp base using the stovebolts, washers and wingnuts.



19) Use the three rubber bands and stretch them around the Clamp base and each Clamp arm.



20) Using a 1" stove bolt attach the completed clamp assemblies to each side of the stand.



This completes your stand! Adjust the wing nuts to the desired height or fold the entire stand down for transport and storage.

